

# Atlantis

MARINE SERVICE LTD.

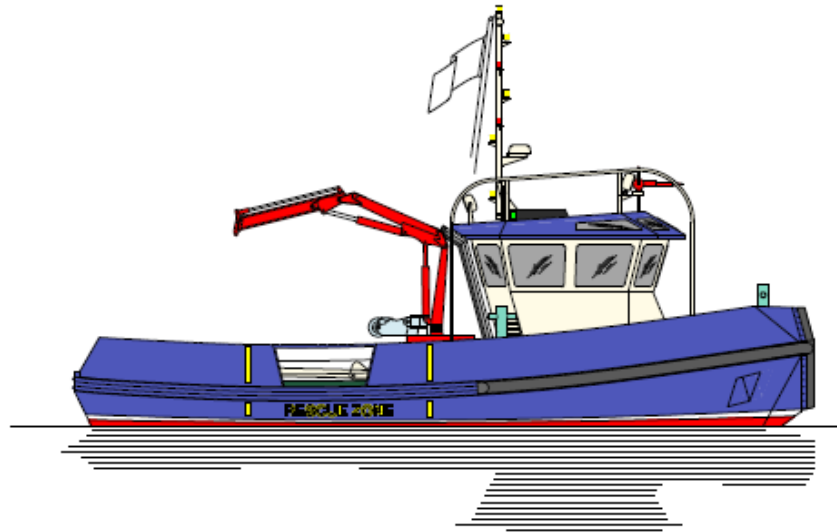

**AMS BOATYARD**  
**Building of Steel and Aluminium Workboats**  
**Tuzla, Istanbul, Turkey**



## **Main Objectives:**

- **Building of Steel and Aluminum Workboats upto 24 m:**
  - **Multicats, Tug Boats, Mooring Boats**
  - **Crew Boats, Pilot Boats**
  - **Patrol and Rescue Boats**
  - **Ambulance Boats**
  - **Anti-pollution Boats**
  - **Barges, Landing Crafts**
- **Alternative Lighter Construction by HDPE**
- **Yachts**



## **Our Vision:**

- Our vision is to be the best boat builder capable to cover all requirements of our world-wide clients in the maritime industry.

## **Our Mission:**

- Be customer focused
- Remain reliable, honest and friendly
- Grow with careful steps

## **Our Values:**

- Transparency, honesty and discipline in all we do
- Commitment to excellence and customer satisfaction

## Certificates:



**We are in Istanbul, Turkey....**



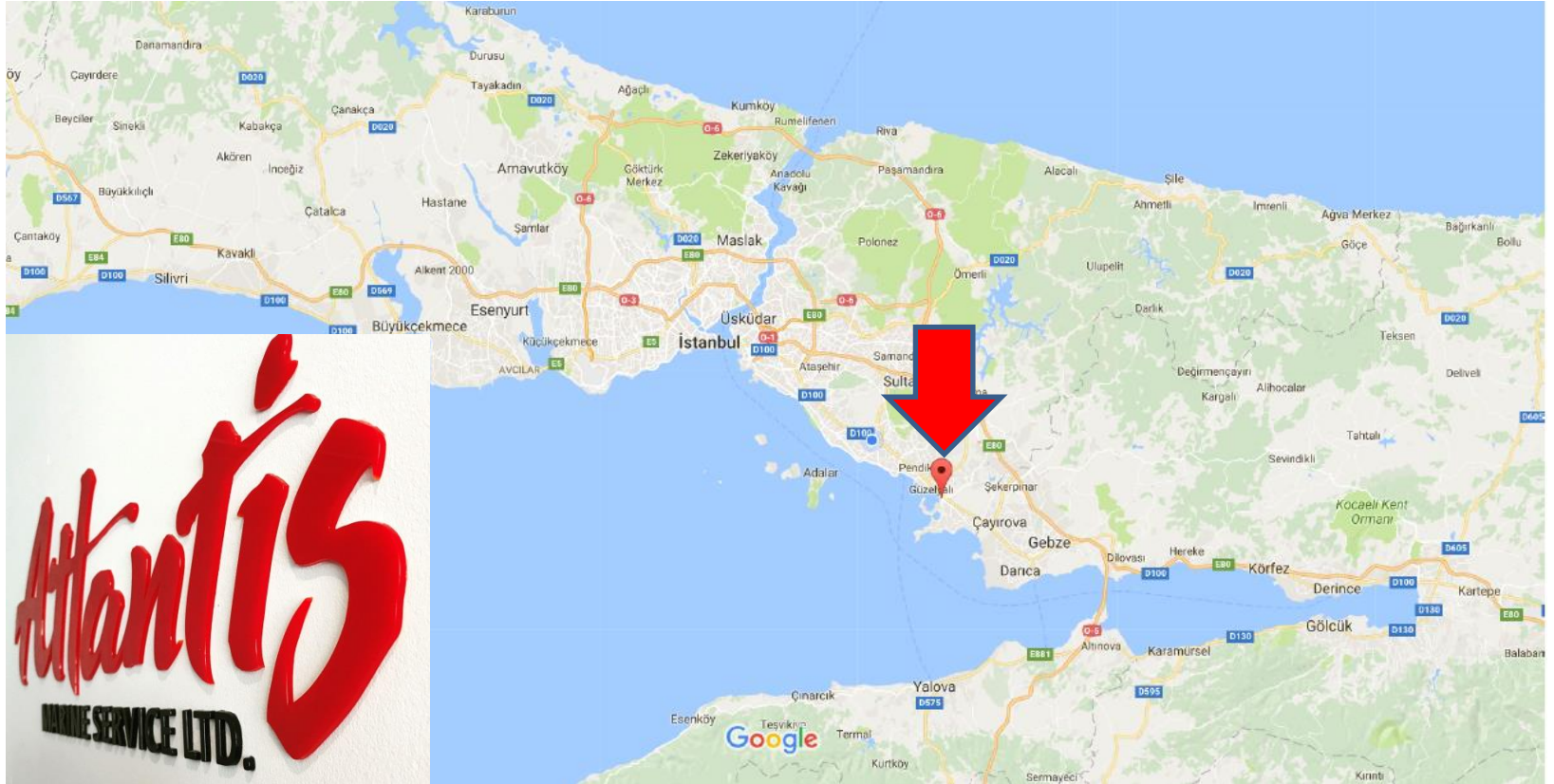

**AMS Boatyard in Tuzla/Istanbul/Turkey**





**AMS Boatyard in Tuzla/Istanbul/Turkey**



**AMS Boatyard in Tuzla/Istanbul/Turkey**





**AMS Boatyard in Tuzla/Istanbul/Turkey**



**AMS Boatyard in Tuzla/Istanbul/Turkey**





**AMS Boatyard in Tuzla/Istanbul/Turkey**



**AMS Boatyard in Tuzla/Istanbul/Turkey**





## **Capacity of Boatyard:**

- **Boatyard dimensions 25x12 m with ceiling height of 10 m.**
- **Max. boat length to be built: 24 m.**
- **Max. boat height to be built: 8 m.**
- **Max. boat weight to be built: 100 ton.**
- **Head crane capacity: SWL 10 ton + SWL 5 ton.**
- **Accessible mobile crane capacity: SWL 100 ton.**
- **Means of launching: conventional slipway by pulleys and ropes.**
- **Distance from gate to slipway: 30 m.**



## Management Structure:

- **Caner Ararat:**
  - **Owner & Managing Partner**
  - **Naval Architect & Marine Engineer**
  - **Experience: 31 years**
  - **Project Responsibilities: Marketing, Procurement, Admin.**
  
- **Cuneyt Niran:**
  - **Owner & Managing Partner**
  - **Naval Architect & Marine Engineer**
  - **Experience: 31 years**
  - **Project Responsibilities: Subcontractors, Safety, Admin.**

## Workforce:



- 4 Naval Architects and Marine Engineers
- 10 permanent workers
- Unlimited workforce from local sub-contractors
- Design and Engineering support from local design office
- Local office available for IACS member class societies



### **Activities Performed In-House by Own Staff and Sub-Contractors:**

- **Hull Fabrication and Painting**
- **Piping and Outfitting**
- **Machinery, Equipment and Electricity**
- **Carpentry**
- **Launching and Trials**

### **Activities Outsourced:**

- **Design and Engineering**
- **Steel and Aluminium CNC Cutting**
- **NDT**
- **Classification**





## **New Building Reference List:**

- **AMS-001:**
  - **12x5m Modular Multi Cat Workboat/ Symbion Power Lake Kivu Ltd.**
- **AMS-002:**
  - **12x5m Modular Multi Cat Workboat/ Symbion Power Lake Kivu Ltd.**
- **AMS-003:**
  - **13x5,4m Harbour Tug Workboat / Wind is Our Friend CV**
- **AMS-004:**
  - **22x9m Multi Cat Workboat / For sale**

MACDUFF SHIP DESIGN  
13.0 m HARBOUR TUG

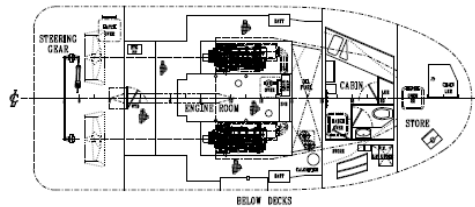
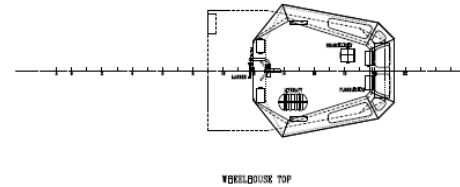
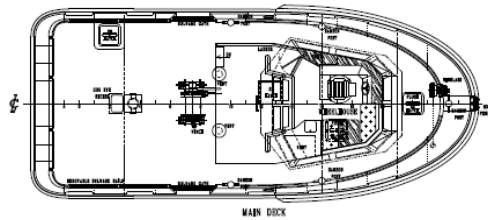
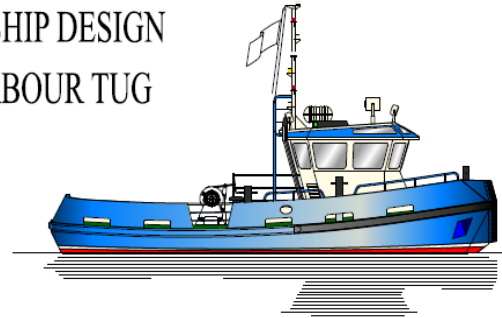
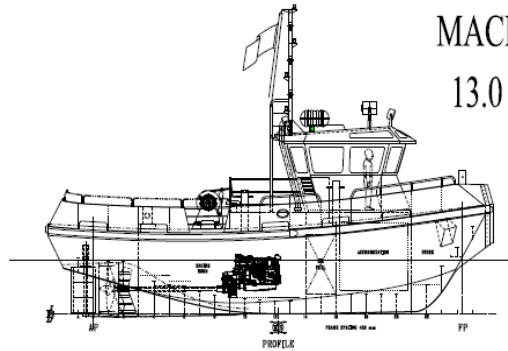

PRINCIPAL DIMENSIONS

LENGTH O.A. (Hull)	13.00 m
LENGTH B.P.	10.97 m
BREADTH MLD.	5.40 m
DEPTH MLD.	2.47 m

NO.	DESCRIPTION	UNIT	VALUE	UNIT
1	LENGTH O.A. (Hull)	m	13.00	
2	LENGTH B.P.	m	10.97	
3	BREADTH MLD.	m	5.40	
4	DEPTH MLD.	m	2.47	
5	MAX. SPEED	knots	10.0	
6	MAX. FUEL CONSUMPTION	litres/hour	1000	
7	MAX. POWER	kw	100	
8	MAX. TORQUE	kgm	1000	
9	MAX. RPM	rev/min	1000	
10	MAX. FUEL CONSUMPTION	litres/hour	1000	
11	MAX. POWER	kw	100	
12	MAX. TORQUE	kgm	1000	
13	MAX. RPM	rev/min	1000	
14	MAX. FUEL CONSUMPTION	litres/hour	1000	
15	MAX. POWER	kw	100	
16	MAX. TORQUE	kgm	1000	
17	MAX. RPM	rev/min	1000	
18	MAX. FUEL CONSUMPTION	litres/hour	1000	
19	MAX. POWER	kw	100	
20	MAX. TORQUE	kgm	1000	
21	MAX. RPM	rev/min	1000	
22	MAX. FUEL CONSUMPTION	litres/hour	1000	
23	MAX. POWER	kw	100	
24	MAX. TORQUE	kgm	1000	
25	MAX. RPM	rev/min	1000	
26	MAX. FUEL CONSUMPTION	litres/hour	1000	
27	MAX. POWER	kw	100	
28	MAX. TORQUE	kgm	1000	
29	MAX. RPM	rev/min	1000	
30	MAX. FUEL CONSUMPTION	litres/hour	1000	
31	MAX. POWER	kw	100	
32	MAX. TORQUE	kgm	1000	
33	MAX. RPM	rev/min	1000	
34	MAX. FUEL CONSUMPTION	litres/hour	1000	
35	MAX. POWER	kw	100	
36	MAX. TORQUE	kgm	1000	
37	MAX. RPM	rev/min	1000	
38	MAX. FUEL CONSUMPTION	litres/hour	1000	
39	MAX. POWER	kw	100	
40	MAX. TORQUE	kgm	1000	
41	MAX. RPM	rev/min	1000	
42	MAX. FUEL CONSUMPTION	litres/hour	1000	
43	MAX. POWER	kw	100	
44	MAX. TORQUE	kgm	1000	
45	MAX. RPM	rev/min	1000	
46	MAX. FUEL CONSUMPTION	litres/hour	1000	
47	MAX. POWER	kw	100	
48	MAX. TORQUE	kgm	1000	
49	MAX. RPM	rev/min	1000	
50	MAX. FUEL CONSUMPTION	litres/hour	1000	
51	MAX. POWER	kw	100	
52	MAX. TORQUE	kgm	1000	
53	MAX. RPM	rev/min	1000	
54	MAX. FUEL CONSUMPTION	litres/hour	1000	
55	MAX. POWER	kw	100	
56	MAX. TORQUE	kgm	1000	
57	MAX. RPM	rev/min	1000	
58	MAX. FUEL CONSUMPTION	litres/hour	1000	
59	MAX. POWER	kw	100	
60	MAX. TORQUE	kgm	1000	
61	MAX. RPM	rev/min	1000	
62	MAX. FUEL CONSUMPTION	litres/hour	1000	
63	MAX. POWER	kw	100	
64	MAX. TORQUE	kgm	1000	
65	MAX. RPM	rev/min	1000	
66	MAX. FUEL CONSUMPTION	litres/hour	1000	
67	MAX. POWER	kw	100	
68	MAX. TORQUE	kgm	1000	
69	MAX. RPM	rev/min	1000	
70	MAX. FUEL CONSUMPTION	litres/hour	1000	
71	MAX. POWER	kw	100	
72	MAX. TORQUE	kgm	1000	
73	MAX. RPM	rev/min	1000	
74	MAX. FUEL CONSUMPTION	litres/hour	1000	
75	MAX. POWER	kw	100	
76	MAX. TORQUE	kgm	1000	
77	MAX. RPM	rev/min	1000	
78	MAX. FUEL CONSUMPTION	litres/hour	1000	
79	MAX. POWER	kw	100	
80	MAX. TORQUE	kgm	1000	
81	MAX. RPM	rev/min	1000	
82	MAX. FUEL CONSUMPTION	litres/hour	1000	
83	MAX. POWER	kw	100	
84	MAX. TORQUE	kgm	1000	
85	MAX. RPM	rev/min	1000	
86	MAX. FUEL CONSUMPTION	litres/hour	1000	
87	MAX. POWER	kw	100	
88	MAX. TORQUE	kgm	1000	
89	MAX. RPM	rev/min	1000	
90	MAX. FUEL CONSUMPTION	litres/hour	1000	
91	MAX. POWER	kw	100	
92	MAX. TORQUE	kgm	1000	
93	MAX. RPM	rev/min	1000	
94	MAX. FUEL CONSUMPTION	litres/hour	1000	
95	MAX. POWER	kw	100	
96	MAX. TORQUE	kgm	1000	
97	MAX. RPM	rev/min	1000	
98	MAX. FUEL CONSUMPTION	litres/hour	1000	
99	MAX. POWER	kw	100	
100	MAX. TORQUE	kgm	1000	

# Harbour Tugboats

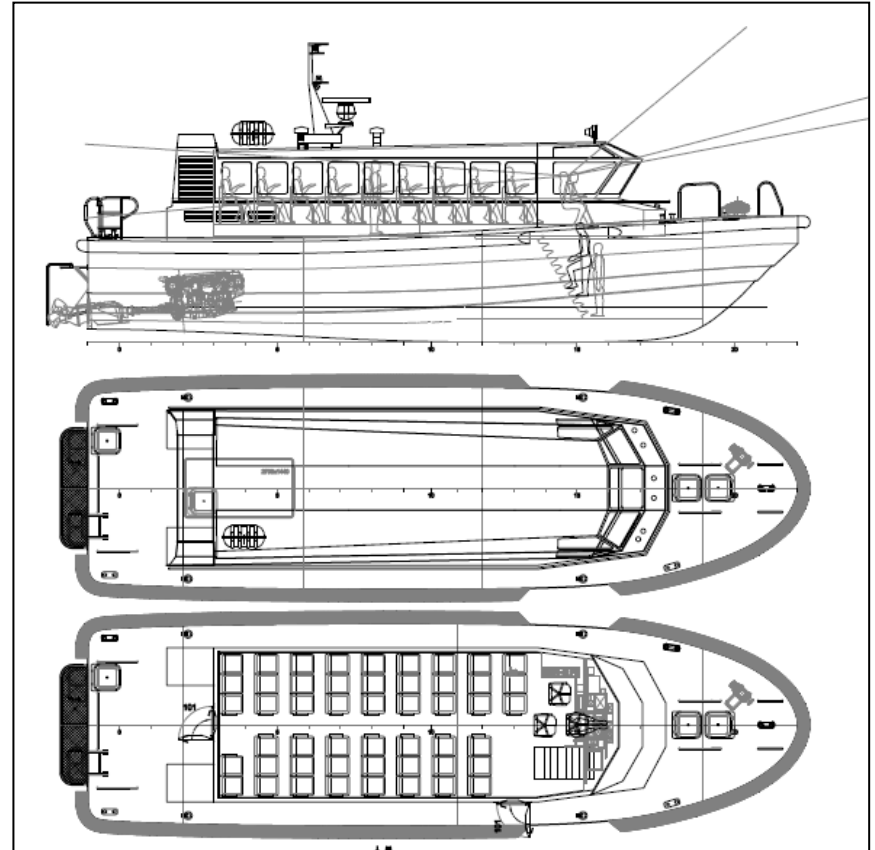
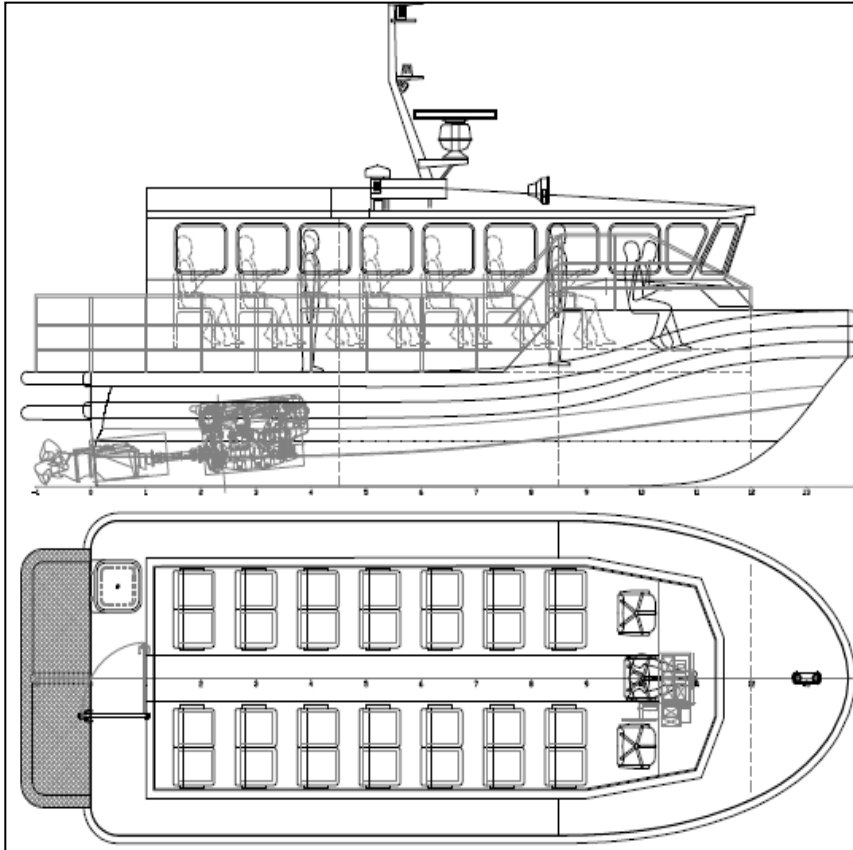

**Aluminum High Speed Crew Boats**

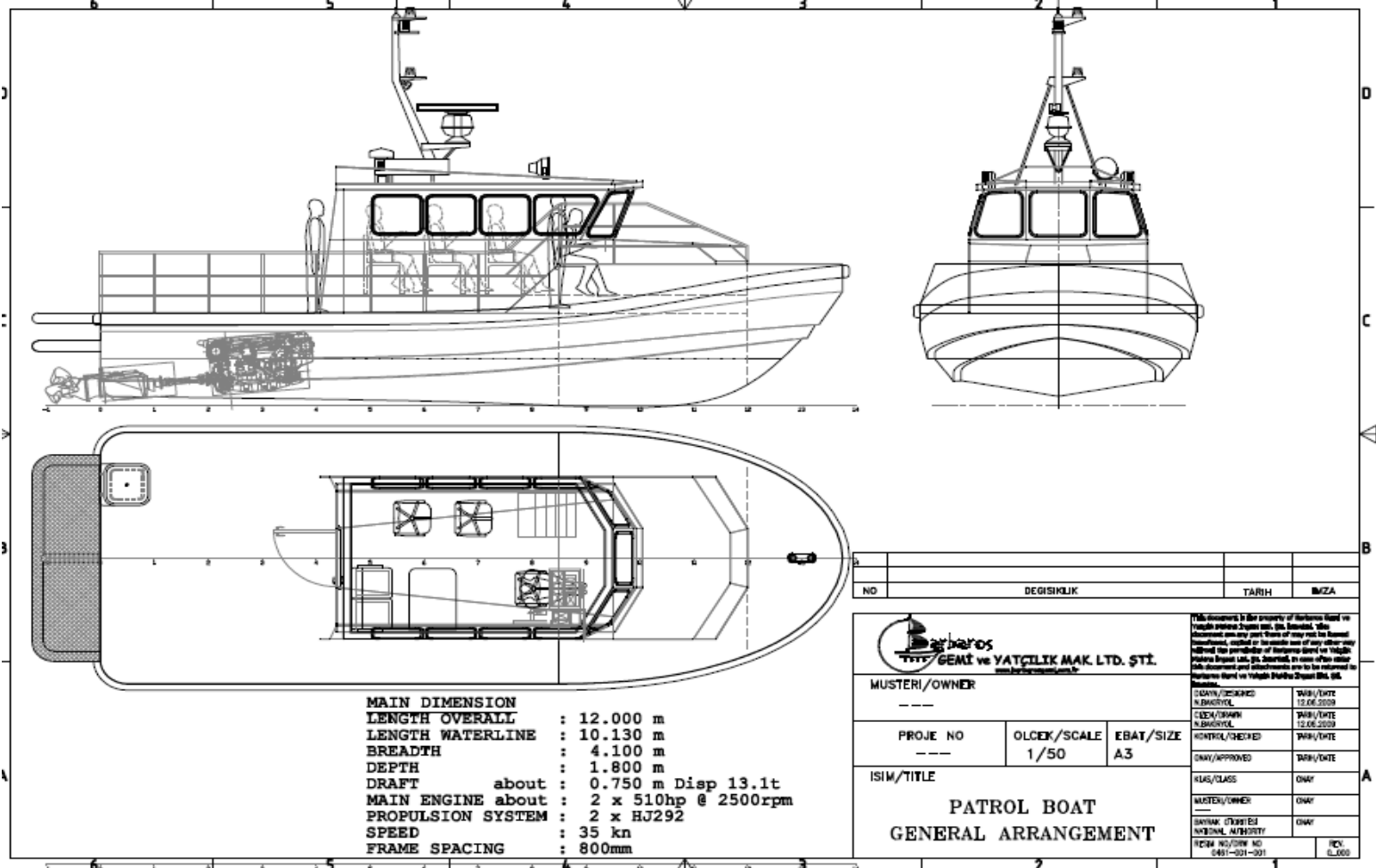

## Pilot Boats



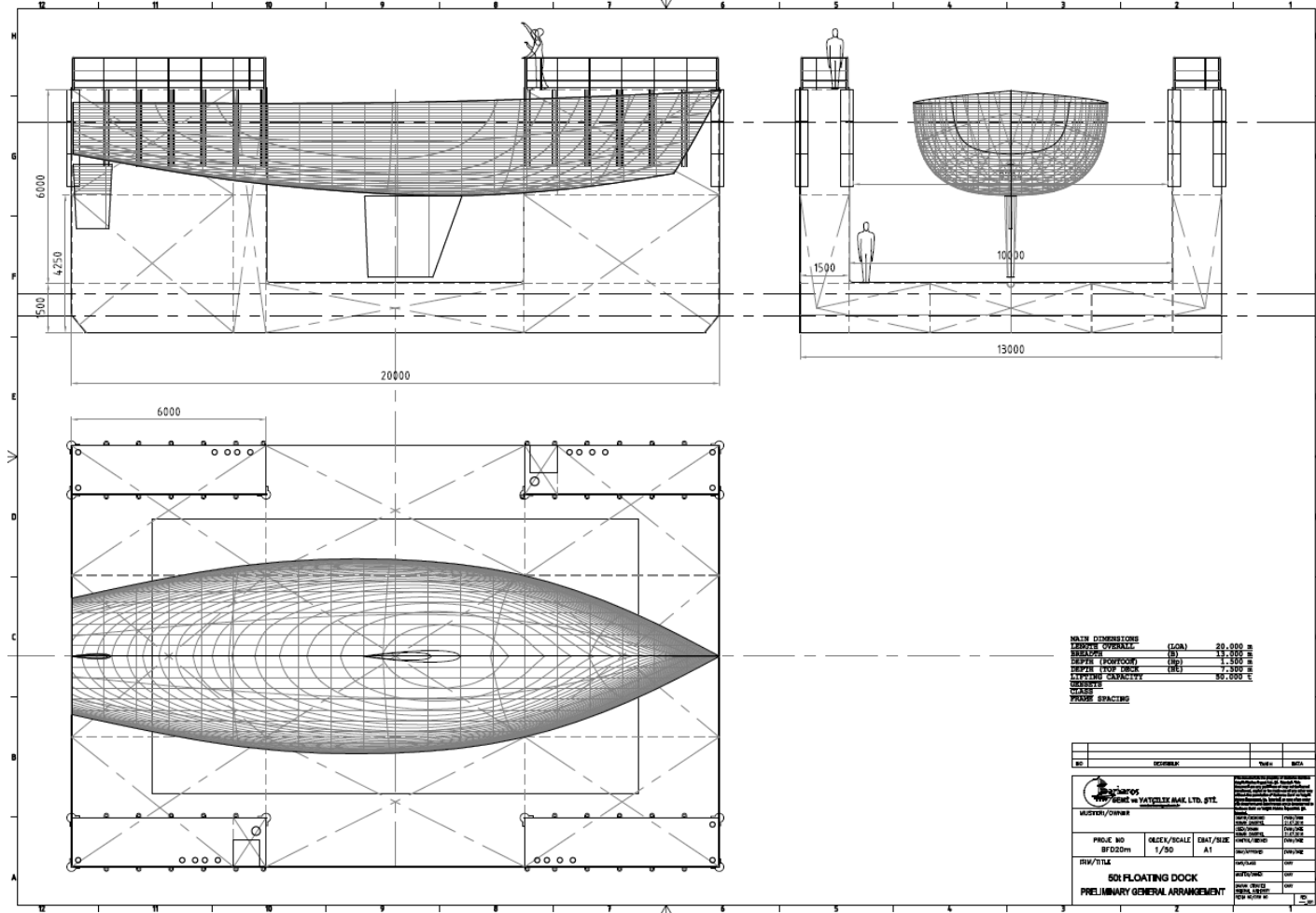

## Floating Docks for Yachts/Workboats

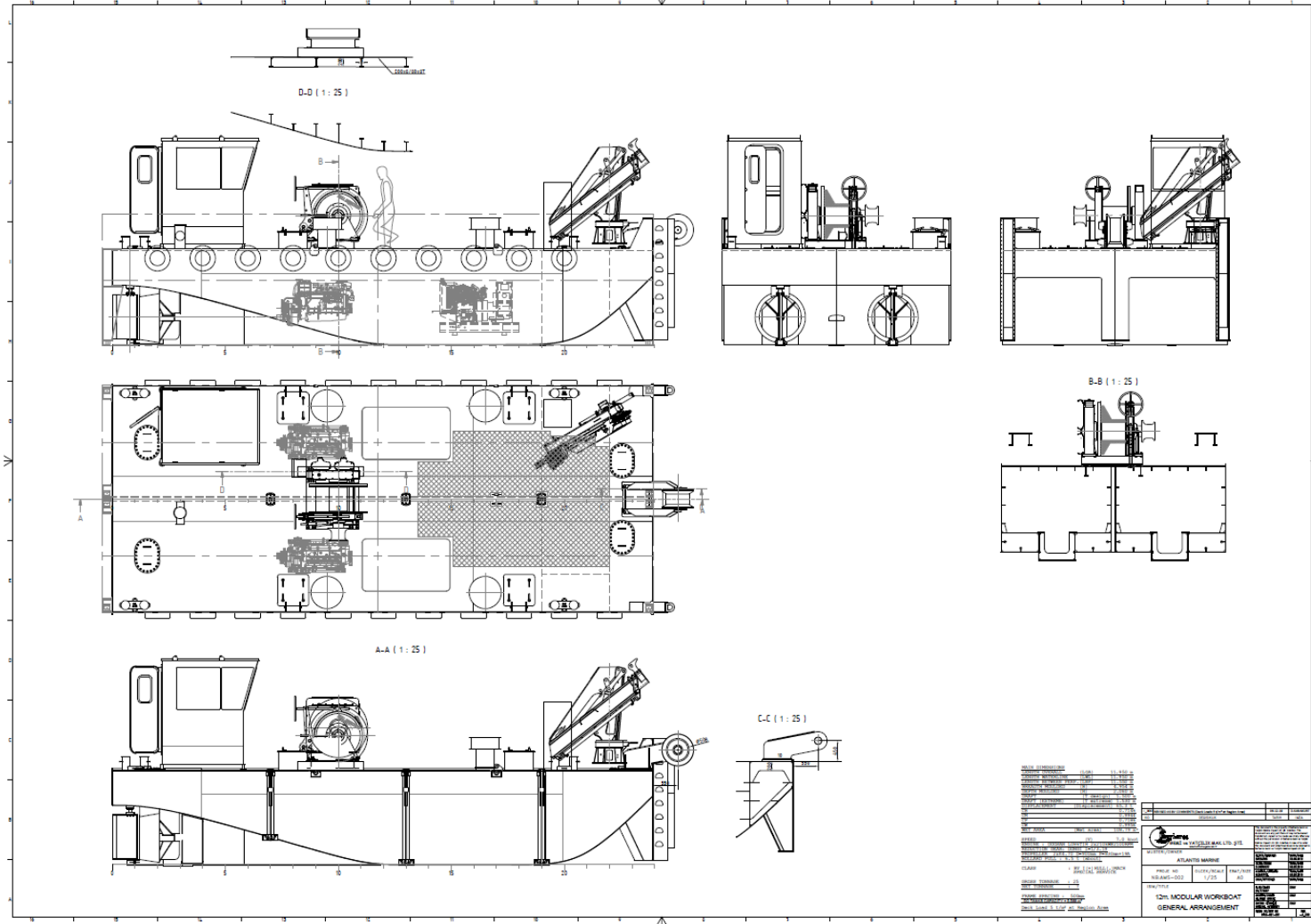

## Modular Multicats

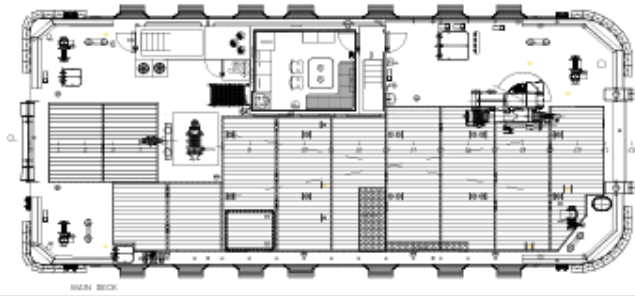
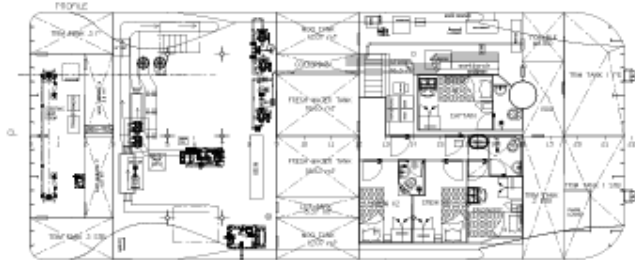
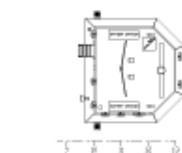
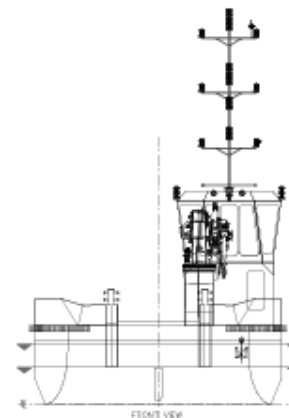
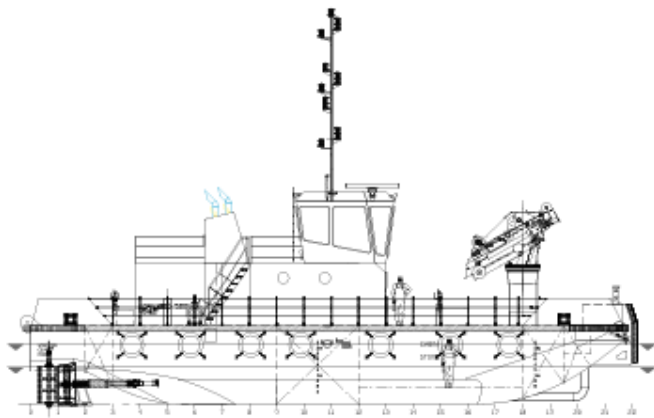
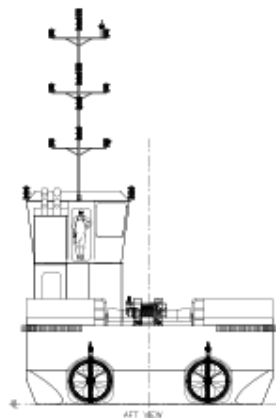

CLASS BY  
U.S. BOAT BUILDING SOCIETY, WOODBRIDGE, VIRGINIA  
PLAN NO. 10000

GENERAL PARTICULARS			
LOA	22.00m	LOA	22.00m
LB	2.80m	LB	2.80m
BEAM	8.00m	BEAM	8.00m
DEPTH (MOOR)	1	1.40m	1.40m
DEPTH (MOOR)	1	2.00m	2.00m
DEPTH	2	2.40m	2.40m
DEPTH (MOOR)	3	3.00m	3.00m
DEPTH (MOOR)	4	3.60m	3.60m
DEPTH (MOOR)	5	4.20m	4.20m
DEPTH (MOOR)	6	4.80m	4.80m
DEPTH (MOOR)	7	5.40m	5.40m
DEPTH (MOOR)	8	6.00m	6.00m
DEPTH (MOOR)	9	6.60m	6.60m
DEPTH (MOOR)	10	7.20m	7.20m
DEPTH (MOOR)	11	7.80m	7.80m
DEPTH (MOOR)	12	8.40m	8.40m
DEPTH (MOOR)	13	9.00m	9.00m
DEPTH (MOOR)	14	9.60m	9.60m
DEPTH (MOOR)	15	10.20m	10.20m
DEPTH (MOOR)	16	10.80m	10.80m
DEPTH (MOOR)	17	11.40m	11.40m
DEPTH (MOOR)	18	12.00m	12.00m
DEPTH (MOOR)	19	12.60m	12.60m
DEPTH (MOOR)	20	13.20m	13.20m
DEPTH (MOOR)	21	13.80m	13.80m
DEPTH (MOOR)	22	14.40m	14.40m
DEPTH (MOOR)	23	15.00m	15.00m
DEPTH (MOOR)	24	15.60m	15.60m
DEPTH (MOOR)	25	16.20m	16.20m
DEPTH (MOOR)	26	16.80m	16.80m
DEPTH (MOOR)	27	17.40m	17.40m
DEPTH (MOOR)	28	18.00m	18.00m
DEPTH (MOOR)	29	18.60m	18.60m
DEPTH (MOOR)	30	19.20m	19.20m
DEPTH (MOOR)	31	19.80m	19.80m
DEPTH (MOOR)	32	20.40m	20.40m
DEPTH (MOOR)	33	21.00m	21.00m
DEPTH (MOOR)	34	21.60m	21.60m
DEPTH (MOOR)	35	22.20m	22.20m
DEPTH (MOOR)	36	22.80m	22.80m
DEPTH (MOOR)	37	23.40m	23.40m
DEPTH (MOOR)	38	24.00m	24.00m
DEPTH (MOOR)	39	24.60m	24.60m
DEPTH (MOOR)	40	25.20m	25.20m
DEPTH (MOOR)	41	25.80m	25.80m
DEPTH (MOOR)	42	26.40m	26.40m
DEPTH (MOOR)	43	27.00m	27.00m
DEPTH (MOOR)	44	27.60m	27.60m
DEPTH (MOOR)	45	28.20m	28.20m
DEPTH (MOOR)	46	28.80m	28.80m
DEPTH (MOOR)	47	29.40m	29.40m
DEPTH (MOOR)	48	30.00m	30.00m
DEPTH (MOOR)	49	30.60m	30.60m
DEPTH (MOOR)	50	31.20m	31.20m
DEPTH (MOOR)	51	31.80m	31.80m
DEPTH (MOOR)	52	32.40m	32.40m
DEPTH (MOOR)	53	33.00m	33.00m
DEPTH (MOOR)	54	33.60m	33.60m
DEPTH (MOOR)	55	34.20m	34.20m
DEPTH (MOOR)	56	34.80m	34.80m
DEPTH (MOOR)	57	35.40m	35.40m
DEPTH (MOOR)	58	36.00m	36.00m
DEPTH (MOOR)	59	36.60m	36.60m
DEPTH (MOOR)	60	37.20m	37.20m
DEPTH (MOOR)	61	37.80m	37.80m
DEPTH (MOOR)	62	38.40m	38.40m
DEPTH (MOOR)	63	39.00m	39.00m
DEPTH (MOOR)	64	39.60m	39.60m
DEPTH (MOOR)	65	40.20m	40.20m
DEPTH (MOOR)	66	40.80m	40.80m
DEPTH (MOOR)	67	41.40m	41.40m
DEPTH (MOOR)	68	42.00m	42.00m
DEPTH (MOOR)	69	42.60m	42.60m
DEPTH (MOOR)	70	43.20m	43.20m
DEPTH (MOOR)	71	43.80m	43.80m
DEPTH (MOOR)	72	44.40m	44.40m
DEPTH (MOOR)	73	45.00m	45.00m
DEPTH (MOOR)	74	45.60m	45.60m
DEPTH (MOOR)	75	46.20m	46.20m
DEPTH (MOOR)	76	46.80m	46.80m
DEPTH (MOOR)	77	47.40m	47.40m
DEPTH (MOOR)	78	48.00m	48.00m
DEPTH (MOOR)	79	48.60m	48.60m
DEPTH (MOOR)	80	49.20m	49.20m
DEPTH (MOOR)	81	49.80m	49.80m
DEPTH (MOOR)	82	50.40m	50.40m
DEPTH (MOOR)	83	51.00m	51.00m
DEPTH (MOOR)	84	51.60m	51.60m
DEPTH (MOOR)	85	52.20m	52.20m
DEPTH (MOOR)	86	52.80m	52.80m
DEPTH (MOOR)	87	53.40m	53.40m
DEPTH (MOOR)	88	54.00m	54.00m
DEPTH (MOOR)	89	54.60m	54.60m
DEPTH (MOOR)	90	55.20m	55.20m
DEPTH (MOOR)	91	55.80m	55.80m
DEPTH (MOOR)	92	56.40m	56.40m
DEPTH (MOOR)	93	57.00m	57.00m
DEPTH (MOOR)	94	57.60m	57.60m
DEPTH (MOOR)	95	58.20m	58.20m
DEPTH (MOOR)	96	58.80m	58.80m
DEPTH (MOOR)	97	59.40m	59.40m
DEPTH (MOOR)	98	60.00m	60.00m
DEPTH (MOOR)	99	60.60m	60.60m
DEPTH (MOOR)	100	61.20m	61.20m
DEPTH (MOOR)	101	61.80m	61.80m
DEPTH (MOOR)	102	62.40m	62.40m
DEPTH (MOOR)	103	63.00m	63.00m
DEPTH (MOOR)	104	63.60m	63.60m
DEPTH (MOOR)	105	64.20m	64.20m
DEPTH (MOOR)	106	64.80m	64.80m
DEPTH (MOOR)	107	65.40m	65.40m
DEPTH (MOOR)	108	66.00m	66.00m
DEPTH (MOOR)	109	66.60m	66.60m
DEPTH (MOOR)	110	67.20m	67.20m
DEPTH (MOOR)	111	67.80m	67.80m
DEPTH (MOOR)	112	68.40m	68.40m
DEPTH (MOOR)	113	69.00m	69.00m
DEPTH (MOOR)	114	69.60m	69.60m
DEPTH (MOOR)	115	70.20m	70.20m
DEPTH (MOOR)	116	70.80m	70.80m
DEPTH (MOOR)	117	71.40m	71.40m
DEPTH (MOOR)	118	72.00m	72.00m
DEPTH (MOOR)	119	72.60m	72.60m
DEPTH (MOOR)	120	73.20m	73.20m
DEPTH (MOOR)	121	73.80m	73.80m
DEPTH (MOOR)	122	74.40m	74.40m
DEPTH (MOOR)	123	75.00m	75.00m
DEPTH (MOOR)	124	75.60m	75.60m
DEPTH (MOOR)	125	76.20m	76.20m
DEPTH (MOOR)	126	76.80m	76.80m
DEPTH (MOOR)	127	77.40m	77.40m
DEPTH (MOOR)	128	78.00m	78.00m
DEPTH (MOOR)	129	78.60m	78.60m
DEPTH (MOOR)	130	79.20m	79.20m
DEPTH (MOOR)	131	79.80m	79.80m
DEPTH (MOOR)	132	80.40m	80.40m
DEPTH (MOOR)	133	81.00m	81.00m
DEPTH (MOOR)	134	81.60m	81.60m
DEPTH (MOOR)	135	82.20m	82.20m
DEPTH (MOOR)	136	82.80m	82.80m
DEPTH (MOOR)	137	83.40m	83.40m
DEPTH (MOOR)	138	84.00m	84.00m
DEPTH (MOOR)	139	84.60m	84.60m
DEPTH (MOOR)	140	85.20m	85.20m
DEPTH (MOOR)	141	85.80m	85.80m
DEPTH (MOOR)	142	86.40m	86.40m
DEPTH (MOOR)	143	87.00m	87.00m
DEPTH (MOOR)	144	87.60m	87.60m
DEPTH (MOOR)	145	88.20m	88.20m
DEPTH (MOOR)	146	88.80m	88.80m
DEPTH (MOOR)	147	89.40m	89.40m
DEPTH (MOOR)	148	90.00m	90.00m
DEPTH (MOOR)	149	90.60m	90.60m
DEPTH (MOOR)	150	91.20m	91.20m
DEPTH (MOOR)	151	91.80m	91.80m
DEPTH (MOOR)	152	92.40m	92.40m
DEPTH (MOOR)	153	93.00m	93.00m
DEPTH (MOOR)	154	93.60m	93.60m
DEPTH (MOOR)	155	94.20m	94.20m
DEPTH (MOOR)	156	94.80m	94.80m
DEPTH (MOOR)	157	95.40m	95.40m
DEPTH (MOOR)	158	96.00m	96.00m
DEPTH (MOOR)	159	96.60m	96.60m
DEPTH (MOOR)	160	97.20m	97.20m
DEPTH (MOOR)	161	97.80m	97.80m
DEPTH (MOOR)	162	98.40m	98.40m
DEPTH (MOOR)	163	99.00m	99.00m
DEPTH (MOOR)	164	99.60m	99.60m
DEPTH (MOOR)	165	100.20m	100.20m
DEPTH (MOOR)	166	100.80m	100.80m
DEPTH (MOOR)	167	101.40m	101.40m
DEPTH (MOOR)	168	102.00m	102.00m
DEPTH (MOOR)	169	102.60m	102.60m
DEPTH (MOOR)	170	103.20m	103.20m
DEPTH (MOOR)	171	103.80m	103.80m
DEPTH (MOOR)	172	104.40m	104.40m
DEPTH (MOOR)	173	105.00m	105.00m
DEPTH (MOOR)	174	105.60m	105.60m
DEPTH (MOOR)	175	106.20m	106.20m
DEPTH (MOOR)	176	106.80m	106.80m
DEPTH (MOOR)	177	107.40m	107.40m
DEPTH (MOOR)	178	108.00m	108.00m
DEPTH (MOOR)	179	108.60m	108.60m
DEPTH (MOOR)	180	109.20m	109.20m
DEPTH (MOOR)	181	109.80m	109.80m
DEPTH (MOOR)	182	110.40m	110.40m
DEPTH (MOOR)	183	111.00m	111.00m
DEPTH (MOOR)	184	111.60m	111.60m
DEPTH (MOOR)	185	112.20m	112.20m
DEPTH (MOOR)	186	112.80m	112.80m
DEPTH (MOOR)	187	113.40m	113.40m
DEPTH (MOOR)	188	114.00m	114.00m
DEPTH (MOOR)	189	114.60m	114.60m
DEPTH (MOOR)	190	115.20m	115.20m
DEPTH (MOOR)	191	115.80m	115.80m
DEPTH (MOOR)	192	116.40m	116.40m
DEPTH (MOOR)	193	117.00m	117.00m
DEPTH (MOOR)	194	117.60m	117.60m
DEPTH (MOOR)	195	118.20m	118.20m
DEPTH (MOOR)	196	118.80m	118.80m
DEPTH (MOOR)	197	119.40m	119.40m
DEPTH (MOOR)	198	120.00m	120.00m
DEPTH (MOOR)	199	120.60m	120.60m
DEPTH (MOOR)	200	121.20m	121.20m
DEPTH (MOOR)	201	121.80m	121.80m
DEPTH (MOOR)	202	122.40m	122.40m
DEPTH (MOOR)	203	123.00m	123.00m
DEPTH (MOOR)	204	123.60m	123.60m
DEPTH (MOOR)	205	124.20m	124.20m
DEPTH (MOOR)	206	124.80m	124.80m
DEPTH (MOOR)	207	125.40m	125.40m
DEPTH (MOOR)	208	126.00m	126.00m
DEPTH (MOOR)	209	126.60m	126.60m
DEPTH (MOOR)	210	127.20m	127.20m
DEPTH (MOOR)	211	127.80m	127.80m
DEPTH (MOOR)	212	128.40m	128.40m
DEPTH (MOOR)	213	129.00m	129.00m
DEPTH (MOOR)	214	129.60m	129.60m
DEPTH (MOOR)	215	130.20m	130.20m
DEPTH (MOOR)	216	130.80m	130.80m
DEPTH (MOOR)	217	131.40m	131.40m
DEPTH (MOOR)	218	132.00m	132.00m
DEPTH (MOOR)	219	132.60m	132.60m
DEPTH (MOOR)	220	133.20m	133.20m
DEPTH (MOOR)	221	133.80m	133.80m
DEPTH (MOOR)	222	134.40m	134.40m
DEPTH (MOOR)	223	135.00m	135.00m
DEPTH (MOOR)	224	135.60m	135.60m
DEPTH (MOOR)	225	136.20m	136.20m
DEPTH (MOOR)	226	136.80m	136.80m
DEPTH (MOOR)	227	137.40m	137.40m
DEPTH (MOOR)	228	138.00m	138.00m
DEPTH (MOOR)	229	138.60m	138.60m
DEPTH (MOOR)	230	139.20m	139.20m
DEPTH (MOOR)	231	139.80m	139.80m
DEPTH (MOOR)	232	140.40m	140.40m
DEPTH (MOOR)	233	141.00m	141.00m
DEPTH (MOOR)	234	141.60m	141.60m
DEPTH (MOOR)	235	142.20m	142.20m
DEPTH (MOOR)	236	142.80m	142.80m
DEPTH (MOOR)	237	143.40m	143.40m
DEPTH (MOOR)	238	144.00m	144.00m
DEPTH (MOOR)	239	144.60m	144.60m
DEPTH (MOOR)	240	145.20m	145.20m
DEPTH (MOOR)	241	145.80m	145.80m
DEPTH (MOOR)	242	146.40m	146.40m
DEPTH (MOOR)	243	147.00m	147.00m
DEPTH (MOOR)	244	147.60m	147.60m
DEPTH (MOOR)	245	148.20m	148.20m
DEPTH (MOOR)	246	148.80m	148.80m
DEPTH (MOOR)	247	149.40m	149.40m
DEPTH (MOOR)	248	150.00m	150.00m
DEPTH (MOOR)	249	150.60m	150.60m
DEPTH (MOOR)	250	151.20m	151.20m
DEPTH (MOOR)	251	151.80m	151.80m
DEPTH (MOOR)	252	152.40m	152.40m
DEPTH (MOOR)	253	153.00m	153.00m
DEPTH (MOOR)	254	153.60m	153.60m
DEPTH (MOOR)			



**New Building Experience**



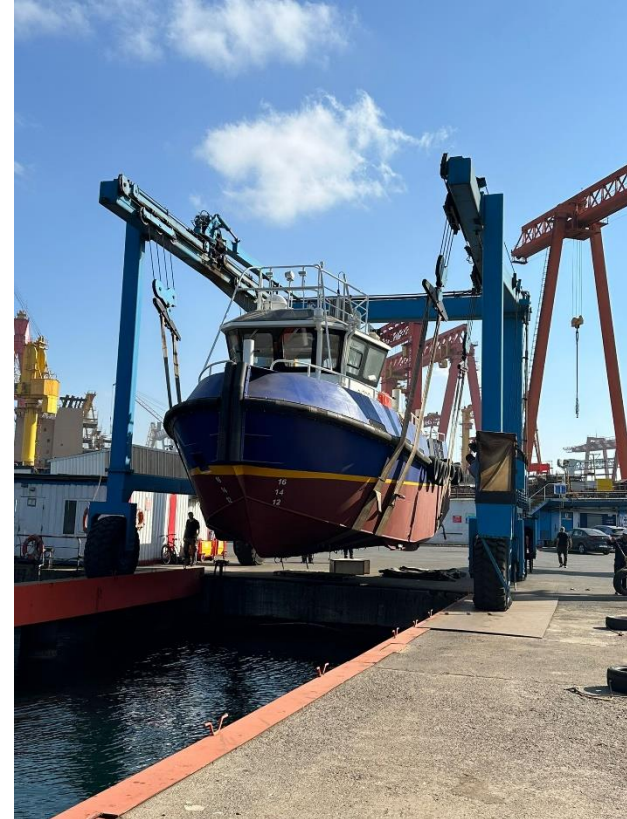

**New Building Experience**

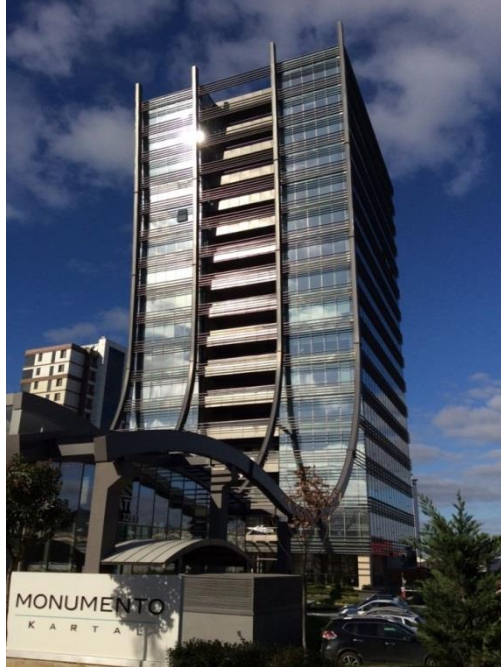

## AMS Head Office in Kartal/Istanbul/Turkey

**ATLANTIS MARINE SERVİS DENİZCİLİK SAN. VE TİC. LTD. STİ.**

Esentepe Mah. Milangaz Cad. 75/A, Monumento Kartal İş Merkezi No:103

Kartal, 34870, İstanbul, **Turkey**

Tel: +90 216 290 12 06

Fax: +90 216 290 12 07

[www.atlantismarine.com.tr](http://www.atlantismarine.com.tr)



## **Caner Ararat**

Managing Partner

Naval Architect & Marine Engineer

Phone: +90 532 3636830

E-mail:

[caner@atlantismarine.com.tr](mailto:caner@atlantismarine.com.tr)

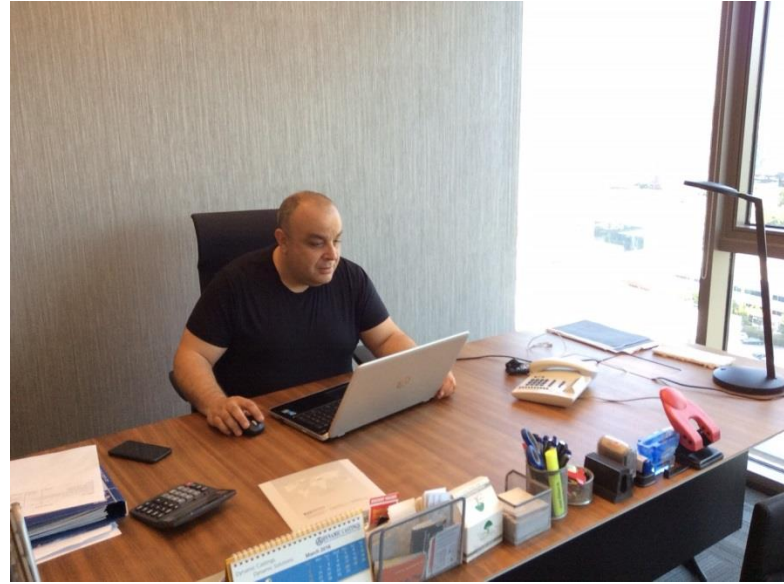

## **Cuneyt Niran**

Managing Partner

Naval Architect & Marine Engineer

Oceangoing Chief Engineer

Phone: +90 532 3170848

E-mail:

[cniran@atlantismarine.com.tr](mailto:cniran@atlantismarine.com.tr)